

1. Measure and Mark
2. Create a Score Line
3. Mark on the Back Side
4. Snap by Hand
5. Strike with a Chisel
6. Create "Feet"
7. Special Shape

YOU WILL NEED:

- Scoring tool, awl, or similar
- Chisel
- Hammer
- Construction adhesive
- Tape measure

Slate is a non-renewable natural resource that we are committed to utilizing as effectively as possible in our slate production. However, you can also maximize the use of slate – every piece and scrap can be used in one way or another.

1. Measure and Mark

Measure the desired size of the tray and mark it on the flag.

2. Create a Score Line

Score along a plank or similar using a scoring tool or something appropriate.



3. Mark on the Back Side

Mark on the back to indicate where the score line is on the opposite side.

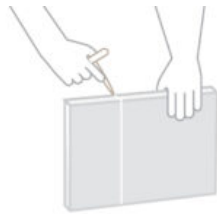

4. Snap by Hand

If the slab is thin and you need to remove a large piece, you can snap it by hand: place something underneath, such as a scoring needle or a plank, and apply pressure on each side of the score line.

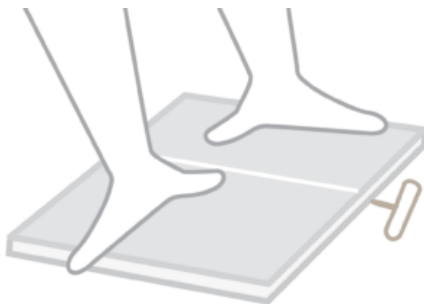

5. Strike with a Chisel

If the slab is thicker or you need to cut off a relatively small

part, use a chisel.

Place something underneath, such as a scoring needle or a plank, and strike the chisel along the score line.



6. Create "Feet"

Chisel off a strip (make a score line and then chisel) and cut it into small squares. These will become the feet.

Use construction adhesive to glue them to each corner on the back.



7. Special Shape

To make a slate board, follow the same process with the exception of the top where the handle is. Draw the desired shape with chalk on the slab and cut it with an angle grinder.

